

**A Global Gateway, Now Within Reach**  
Start your trip from Kobe Airport!



Hello, world!  
神戸空港から海外へ

2006年の開港から19年、  
約5,000万人を運んできた  
神戸空港が世界とつながります！  
新ターミナルの魅力や就航都市ガイドなど  
たっぷり特集します。

If you have any questions about ward  
office procedures, financial support for  
raising children, etc.

**Call the Kobe International  
Community Center (KICC)!**

☎ 078-742-8721 (11 languages)



↑ Scan here  
to visit the  
website!



Edited and Translated by:  
Kobe City Community Engagement Division, Kobe City International Division

**A Global Gateway, Now Within Reach**  
Start your trip from Kobe Airport!

神戸空港の魅力 1



40 flights from Kobe  
Airport every week,  
to 5 different cities in  
East Asia!

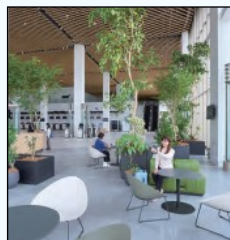

就航都市  
ガイド



神戸空港の魅力 2



The airport has a warm  
design, with a forest theme!

神戸空港の魅力 3



Located about 20 minutes  
from the city center;  
it's close and compact!

神戸空港の魅力 4



Boarding procedures are  
completed on one floor!

**3 Types of Transport Access**



**Bus (Fare: 340 yen)**

If you: ・have large luggage ・want to sit on your way to the airport

Recommended for  
different groups of  
people!



**Port Liner (Fare: 340 yen)**

If you: ・don't want to be late due to traffic ・don't want to wait



**Car (Parking: 150 yen per hour)**

1,530 yen for 10~24 hours.

If you: ・have infants or elderly people ・need just a one-day use

Further  
Details  
(JPN)→



みんな集まれ

**Ward Festivals**



**Suma Ward: Suma Music Forest**



Spend a day at Suma Rikyu Park, with roses in  
full bloom! Featuring kids' dance performances,  
cheerleading, brass band, and Japanese taiko  
drums. There will also be plenty of Japanese  
gourmet food!

**Date & Time:** Saturday May 24  
11:00AM~5:00PM

**Location:** Suma Rikyu Park  
(Entry is free, parking fee applicable)

Further Details (JPN)→



**Tarumi Ward: Tarumikko Festival**



Enjoy dramatic performances,  
featuring kids' dances,  
traditional arts, and  
Japanese taiko drums, all  
while getting a fantastic view  
of the Akashi Kaikyo Bridge  
in the background! There will  
also be exhibits of vehicles like fire trucks and police  
motorcycles, making it a fun day for both children and  
adults.

**Date & Time:** Saturday, May 24  
10:00~4:00PM

**Location:** Maiko Park  
(Higashimaiko-cho, Tarumi Ward)

Further Details (JPN)→



## Nishi Ward: Festival of Greenery & Sun



Watch impressive performances of lion dances and Japanese taiko drums, as well as local Iwaoka dances, at this ward festival! There will be plenty of food stalls, and a raffle as well!

**Date & Time:** Saturday, May 24  
12:00PM~5:00PM

**Location:** Plently Plaza  
(5-Chome Kojidai)

[Further Details \(JPN\)→](#)



## Nada Ward: Rokko Family Festival

Featuring an opening performance with seven *danjiri* floats! Come enjoy the exciting festival vibes with food stalls and games!



**Date & Time:** Saturday, May 31  
11:00AM~5:00PM

**Location:** Oji Athletics Stadium Square

[Further Details \(JPN\)→](#)



## Kita Ward: Kitakita Festival



Featuring stage performances, and a children's *mikoshi* (portable shrine)! A fun festival where everyone can enjoy the local shops, stalls, and hands-on workshop booths.

**Date & Time:** Saturday, June 7  
12:00PM~5:00PM

**Location:** Shiawase no Mura, Open Lawn

[Further Details \(JPN\)→](#)



## For Plumbing Issues, Contact the Water Repair Reception Center

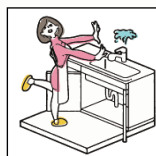

Faucet water leak

Clogged/overflowing toilet

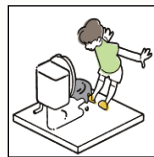

Clogged pipes

There have been incidents where people have requested repairs for water leaks or toilet clogs, and have been charged very high prices by malicious companies. If you encounter any issues, please first consult with the Kobe City's Water Repair Reception Center. They will introduce you to City-authorized contractors.

**Inquiries:** 0120-976-194  
(available 24/7, 365 days a year)

[Further Details \(JPN\)→](#)



## Now Recruiting! Kobe Marathon 2025

Enjoy Kobe's scenic views in a brand new way!  
This year's course will be a seaside coastal route!



Recruitment for runners for the Kobe Marathon has officially started! A new quota has opened for Kobe and Akashi citizens.

In addition, in commemoration of the 30th anniversary of the Great Hanshin-Awaji Earthquake, a special quota for runners under 30 years old has also been established for this year's race. We are also looking for volunteers!

**Date:** Sunday, November 16

**Apply:** via website until Monday, June 2, 5:00PM.  
Selection will be decided by lottery.

**Inquiries:** 0570-018-501

※Inquiry center available on weekdays,  
10:00AM~5:00PM

[Further Details \(JPN\)→](#)



## Must-Try Events!



### Riverside Fish Market (Hyogo Ward)

The Central Wholesale Market is open to the public twice a year, and its public viewing day is quickly approaching!

You can browse the market while learning about seasonal fish and tasty cooking methods from food professionals. In addition to tuna cutting and immediate sales, there will be also family-oriented activities such as workshops on handling fish and a how to handle fish, and a touch pool! Take this opportunity to rediscover the deliciousness of fish!

**Date & Time:** Saturday, May 24 9:30AM~11:30AM

**Venue:** Central Wholesale Market

**Admission:** Free

**Inquiries:** 078-672-7600

[Further Details \(JPN\)→](#)



### Rice Planting Festival (Kita Ward)

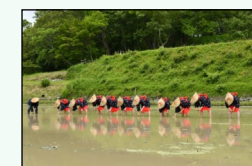

Stop by the Aina Satoyama Rice Planting Festival, where you can watch a demonstration of traditional rice planting and a performance of Japanese taiko drums! Then on June 1st and 8th, you can try your hand at rice planting and vegetable harvesting yourself!

**Period:** Sunday, May 25 ~ Sunday, June 8

**Location:** Aina Satoyama Park

**Admission:** Free

※Admission is free on May 25 ONLY.

(Some activities may require fees, including admission and parking.)

**Inquiries:** 078-591-8000

[Further Details \(JPN\)→](#)

